

DO NOT SCALE

KEY:

- PLANNING BOUNDARY
- CRAVEN DISTRICT COUNCIL LAND OWNERSHIP BOUNDARY

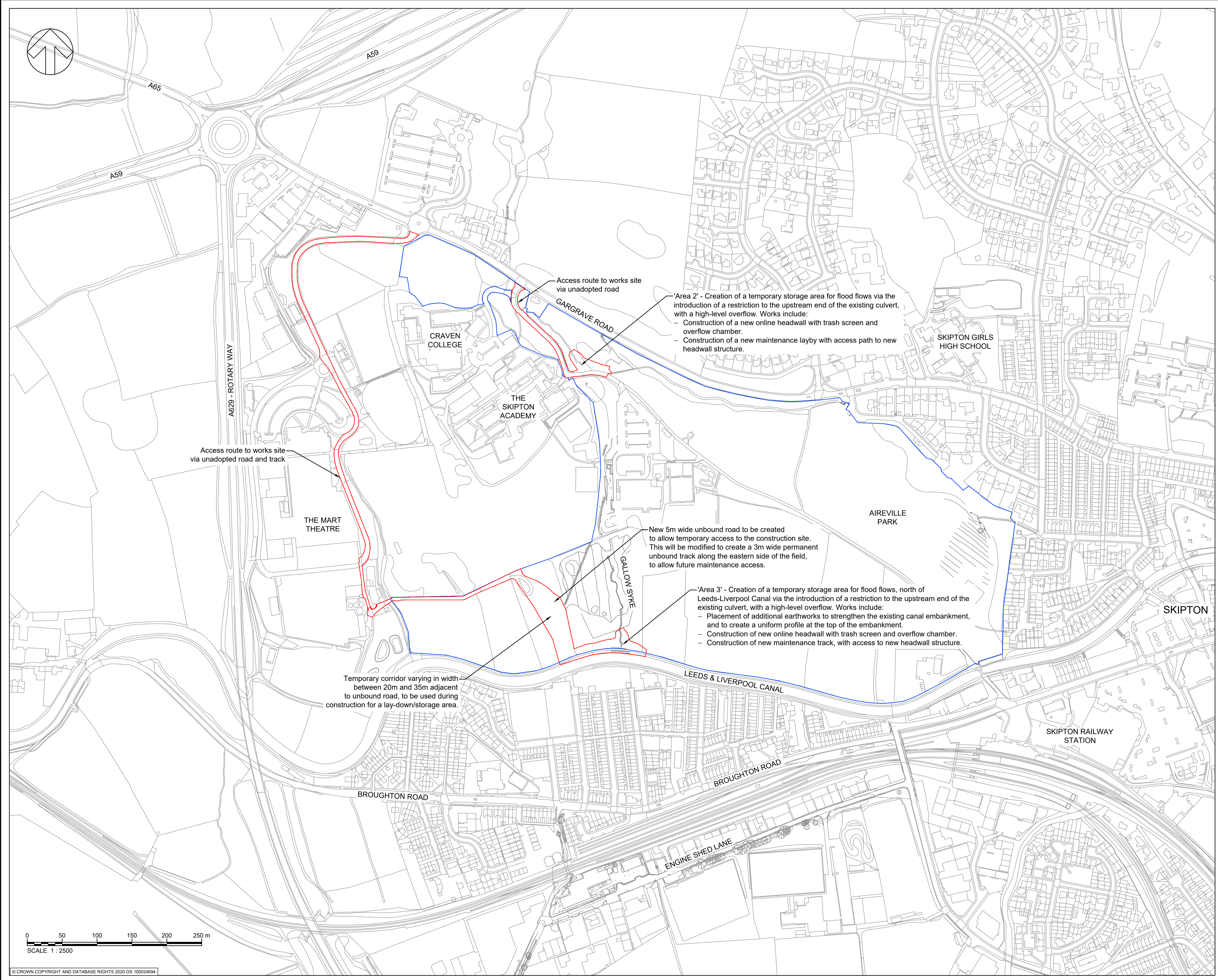

Access route to works site via unadopted road

'Area 2' - Creation of a temporary storage area for flood flows via the introduction of a restriction to the upstream end of the existing culvert, with a high-level overflow. Works include:

- Construction of a new online headwall with trash screen and overflow chamber.
- Construction of a new maintenance layby with access path to new headwall structure.

Access route to works site via unadopted road and track

New 5m wide unbound road to be created to allow temporary access to the construction site. This will be modified to create a 3m wide permanent unbound track along the eastern side of the field, to allow future maintenance access.

'Area 3' - Creation of a temporary storage area for flood flows, north of Leeds-Liverpool Canal via the introduction of a restriction to the upstream end of the existing culvert, with a high-level overflow. Works include:

- Placement of additional earthworks to strengthen the existing canal embankment, and to create a uniform profile at the top of the embankment.
- Construction of new online headwall with trash screen and overflow chamber.
- Construction of new maintenance track, with access to new headwall structure.

Temporary corridor varying in width between 20m and 35m adjacent to unbound road, to be used during construction for a lay-down/storage area.

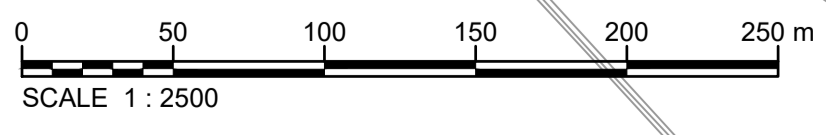

P01	06/08/2020	LM	FIRST ISSUE	AC	RT
REV	DATE	BY	DESCRIPTION	CHK	APP

DRAWING STATUS: S2 - FOR INFORMATION



8 First St, Manchester M15 4GU
T+ 44 (0) 1612 005 000, F+ 44 (0) 161 886 2401
wsp.com

CLIENT: CRAVEN DISTRICT COUNCIL

SITE/PROJECT: ENGINE SHED LANE

TITLE: LOCATION PLAN FOR GALLOW SYKE PLANNING SUBMISSION

SCALE @ A1:	1:2500	CHECKED:	AC	APPROVED:	RT
-------------	--------	----------	----	-----------	----

PROJECT NO:	70072805	DESIGNED:	LM	DRAWN:	LM	DATE:	August 20
-------------	----------	-----------	----	--------	----	-------	-----------

DRAWING NO:	70072805-WSP-HGN-ZZ-DR-CH-0024	REV:	P01
-------------	--------------------------------	------	-----

© WSP UK Ltd

File name: \\UK\WSPGROUP\COMCENTRAL\DATA\PROJECTS\70072805\70072805-ESL-AND-IL-DESIGN\03-WIP\HW-HIGHWAY\03-DRAWINGS\000-MISCELLANEOUS\70072805-WSP-HGN-ZZ-DR-CH-0024-RED-LINE-PLANNING-BOUNDARY.DWG, printed on 07 August 2020 22:47:53, by Turnbull, Robert

© CROWN COPYRIGHT AND DATABASE RIGHTS 2020 OS 100024694